

SUN

1240.LED/..
built-in wall light

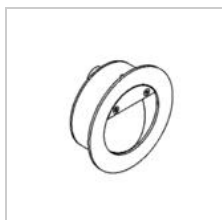

Light distribution



Project _____
Type _____
Nota _____
Quantity _____
Date _____

LED

Lamp type	Led
Quantity	1
Power	1W
Current	350mA
Kelvin	2700K 3000K 4000K
Lumen	
CRI	

Physical

Use type	Interior
Fixation type	Wall
Type of opening	Round
Aperture dimensions	Ø80 mm
Installation depth	55 mm
Dimensions fixture	ø92x55 mm
Spring type	S2 - flat springs
IP protection rating	IP20
Weight	0,3318 kg

Electrical

Connection current	350mA
Fixture class	III
LED driver	Not included
Light source replaceability	Replaceable (LED only) light source by a professional

Project _____

Type _____

Nota _____







Quantity _____

Date _____

SUN

1240.LED/..
built-in wall light

Colours

	11 alu grey	1240.LED.11.B WW CW NW
	13 bronze	1240.LED.13.B WW CW NW
	14 alu satin	1240.LED.14.B WW CW NW
	16 satin gold	1240.LED.16.B WW CW NW
	1M white texture	1240.LED.1M.B WW CW NW
	2M black tex	1240.LED.2M.B WW CW NW

Options

1241A/..	built-in box - no room for transformer	SUN
1241B/..	built-in box - with room for transformer	SUN